

## Australian Kitchen Design Standard dimensions and measurements

When you intend to renovate your kitchen, make sure you are working with the correct dimensions for optimum ergonomics and functionality.

### Benchtop

#### Height

Standard benchtop height is **900 mm**. However, depending on your stature it can range from **850 mm** to **1000 mm**.

#### Depth

Standard depth of a benchtop is **600 mm**. But have a look at your fridge's depth first. If you don't want the fridge to protrude out of your kitchen row, adjust the depth of your benchtop accordingly. See standard fridge dimensions below.

#### Thickness

The most popular benchtop materials in Australia are engineered stones (e.g. Caesarstone, Essastone, Smartstone, Dekton) and laminate finishes. The average thickness of the latter one is around **33 mm**, whereas engineered stone usually comes in **20 mm** or a multiple thereof. If you wish to choose an engineered stone, my recommendation was to go with a thickness of **40 mm** as this looks well-proportioned and classy.

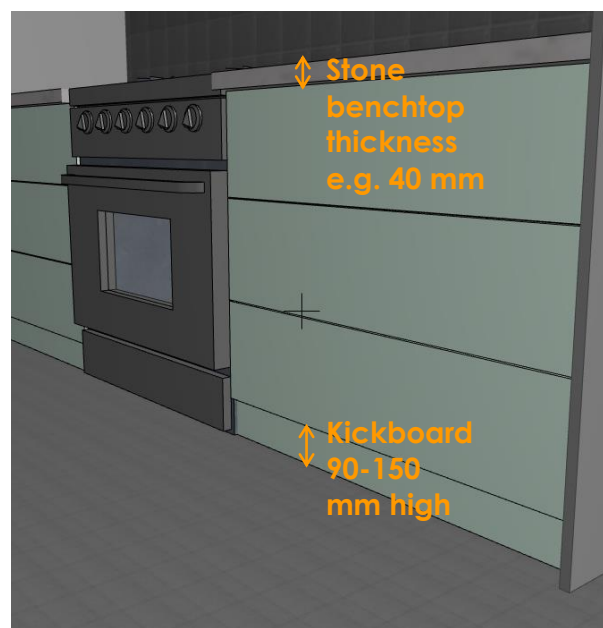

## Island Bench

### Distance

Allow **1200 mm** between the kitchen row and the island bench. If this space is too narrow, it becomes awkward when more than one person is working in the kitchen or the kids are running around your legs. If the distance is too wide, the kitchen becomes less efficient to work in.

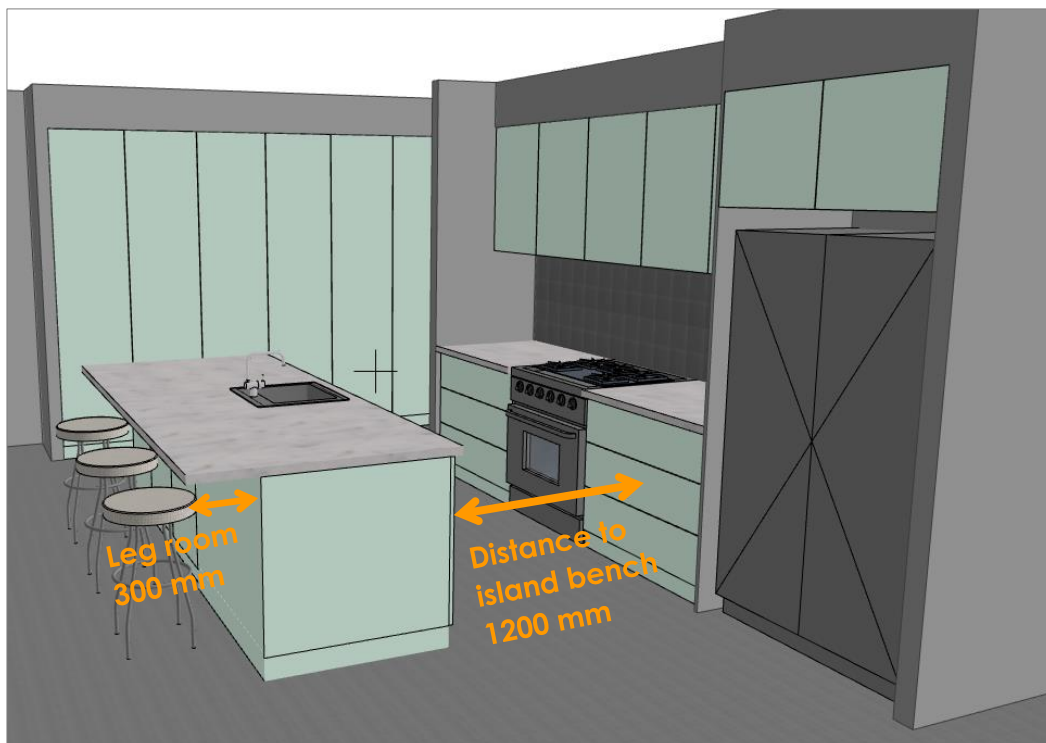

### Width and depth

The size of your kitchen island bench can be as large as your space allows. The only restriction is the width of the slab, if you wish to have an engineered stone. A standard slab size is **3060 mm** by **1440 mm**.

A good island width to work with is **1200 mm**, especially if you plan to place some barstools on the other side. In this case you wish to accommodate for the necessary leg room.

### Leg room

An island bench is a great place to sit on bar stools while having your breakfast or a snack. If your island is at the typical 900 mm height, allow for **300 mm** of leg room underneath the benchtop to sit comfortably. You need to check with your kitchen manufacturer how big an unsupported benchtop overhang can be based on your chosen material.

## Walkway

Plan for **1000 mm** walkway either side of the island bench. This will allow enough space for people to move around without having to turn sideways.

## Fridge

The sizes of fridges vary significantly. For a single door fridge allow around **800 mm** width and **780 mm** depth. A double door fridge is around **1200 mm** wide and **850 mm** deep. If you have selected a fridge, check its required ventilation space in the manual to incorporate this space into your planning.

## Oven

Whether you go for a wall or under bench oven, the standard width is **600 mm**. For large families and for entertainment standard options include **700 mm** and **900 mm**.

## Overhead cupboards

Clearance between benchtop and overhead cupboards to be a minimum of **600 mm**. However, if you wish to install a gas cooktop, you need to allow for at least **650 mm**. Read the manual of the cooktop and rangehood manufacturers and follow their requirements.

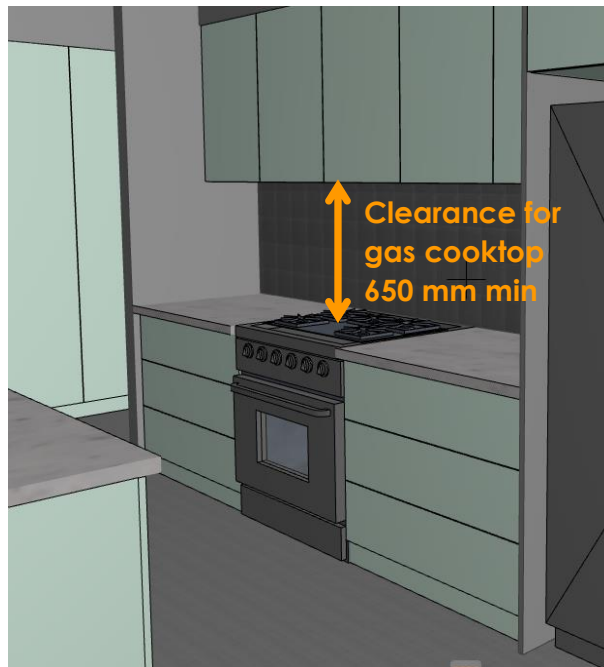

## Dishwasher

Dishwashers and dish drawers are usually **600 mm** wide, but they also come in **450 mm** suitable for an apartment or studio.

## Sink

Sinks come in all shapes and sizes. For a double sink allow for a length of around **800 mm** and a width of **480 mm** plus drainage area. The depth of the sink is around **200 mm**.

If you wish to plan your kitchen sink with a single bowl allow for a length of **550 mm** and a width of around **500 mm**.

## Kickboards

Kickboards are usually between **90 mm** and **150 mm** high and set back from the cabinet's carcass by around **50 mm**.

**If you need help with your kitchen planning, please don't hesitate to contact me.**

Email: [martina@martinahayes.com.au](mailto:martina@martinahayes.com.au)

Mobile: 0434 498 450

The information provided has been compiled using the utmost care. However, no liability can be taken. This document must not be copied or forwarded to a third party without written consent. Thank you for your understanding. Copyright Martina Hayes 2022.